

GARBER COMPANY Seed Easy Spreader

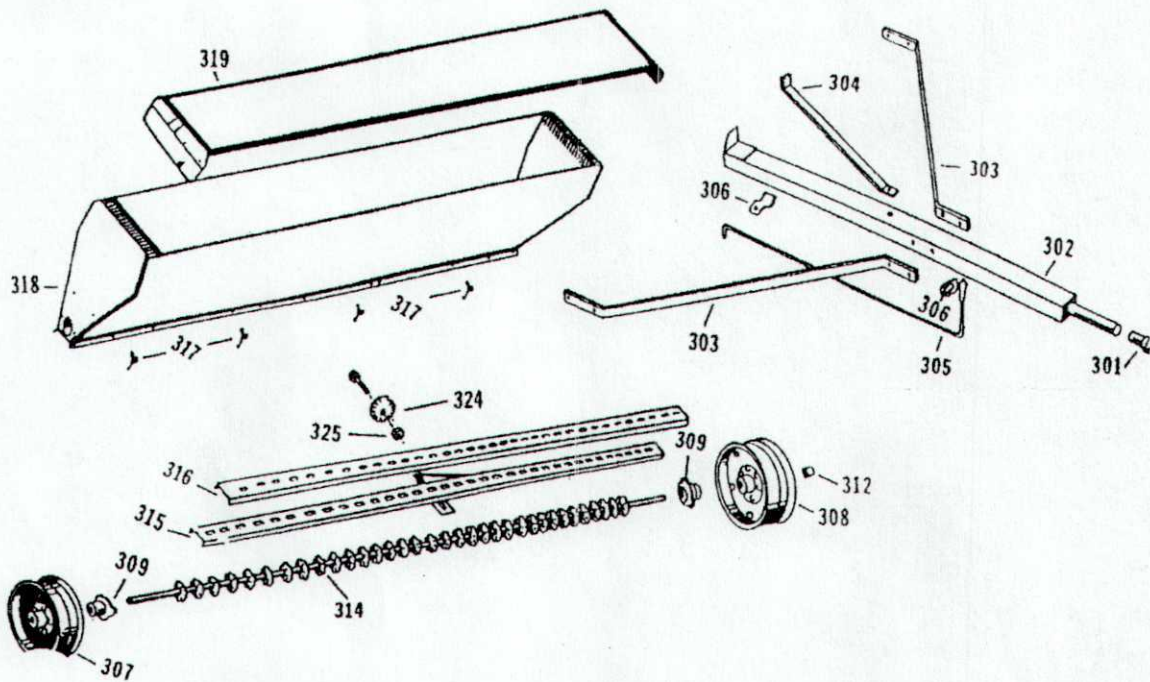

CALIBRATION FOR SPREADER ON REVERSE SIDE

PART NO	DESCRIPTION	NO. REQD	PART NO	DESCRIPTION	NO. REQD
301	Clevis Hitch	1	312	Collar	1
302	Tongue	1	314	Agitator	1
303	Side Brace	2	315	Control Panel	1
304	Top Brace	1	316	Perforated Hopper Panel	1
305	On and Off Lever	1	317	Control Panel Spring	8
306	On and Off Lever Brkt	2	318	Hopper	1
307	Drive Wheel	1	319	Hopper Lid	1
308	Idle Wheel	1	324	Metering Dial	1
309	Bearing	2	325	Jam Nut	1

WHEN ORDERING PARTS, PLEASE SPECIFY MODEL NUMBER OF SPREADER
 GARBER COMPANY, INC. OHIO TOLL-FREE NUMBER 1-800-613-4860

**THE GARBER COMPANY
NEW CARLISLE, OHIO**

SEED TYPE	POUNDS PER 1000 Sq. Ft.	SETTING
Scotts Turf Builder Plus 2	1-1/2	2-1/2
Scotts Turf Builder Plus 2	3	4
Scotts Lawn Seed	3/4	3
Scotts Lawn Seed	1-1/4	4
Scotts Lawn Seed	2	5
Scotts Lawn Seed	2-1/2	6
Scotts Lawn Seed	3-1/4 7	
Scotts Lawn Seed	3-3/4	8
Lawn Seed	3/4	5
Lawn Seed	2-1/4	8
Granular Type Fertilizer	3-1/2	3
Granular Type Fertilizer	6-1/2	4
Granular Type Fertilizer	9	5
Granular Type Fertilizer	12	6
Granular Type Fertilizer	16	7
Granular Type Fertilizer	20-1/2	8

CALIBRATION PROCEDURE

With control lever in "close" position, fill hopper with material to be spread. Place a sheet of cardboard under the full width of the spreader. Raise the drive wheel end, place on a block so that the wheel is just free to run. Set the dial.

Start turning the drive wheel at the rate of one turn per second and move control lever to the "open" position.

Required revolutions for each Model:

36-GD	70
48-GD	60
60-GD	50
72-GD	40

After reaching required revolutions, move control lever to "close" and stop turning.

Collect and weigh the material on the cardboard. This weight is the number of pounds that would cover 1000 square feet. (This will depend upon the density and seed or granular size of the product being spread). Compare this number with the recommended coverage printed on the container. Adjust the metering dial to produce the correct weight per 1000 square feet

Repeat this procedure outlined above until you arrive at the correct dial setting. Record this setting for future use. Multiply # of lbs per 1000 sq ft. By 43.56

SEED-EASY ASSEMBLY INSTRUCTIONS

Tongue Assembly:

Leave all bolts loose till fully assembled. Remove 312 Collar and 308 Idle Wheel. Being careful, slide 307 Drive Wheel away from 318 Hopper. Attach the long side of 303 Tongue Braces to the lower holes of 318 Hopper using four 5/16" x 1" bolts, eight flat washers, four lock washers and four nuts. Insert 305 On and Off lever into 302 Tongue with the Yellow handle cover facing the round end of the Tongue. Secure 305 On and Off lever with one 306 On and Off lever Bracket towards the back of 302 Tongue using one 5/16" x 1" bolt, two flat washers, one lock washer and one nut. Attach 302 Tongue to lower portion of 318 hopper using one 5/16 x 1 bolt, two flat washers, one lock washer and one nut. Secure 303 braces to 302 Tongue using four 5/16" x 1" bolts, eight flat washers, four lock washers and four nuts. Mount 304 Top Brace to upper hole in 318 hopper using one 5/16" x 1" bolt, two flat washers, one lock washer and one nut. Secure 304 Top Brace to 302 Tongue using one 5/16" x 1" bolt, two flat washers, one lock washer and one nut install second 306 On and Off Lever Bracket at this time.

CENTERING OF TONGUE IS ESSENTIAL FOR PROPER OPERATION.

Tighten all bolts at this time. Slide 307 Drive Wheel toward 318 Hopper making sure that no gap exists between wheel and 309 Bearing. Install 308 Idle Wheel: making sure that no gap exists between wheel and 309 Bearing. Install 312 Collar and tighten set screw.

Garber Seeder Company

3-Point Drop Spreader

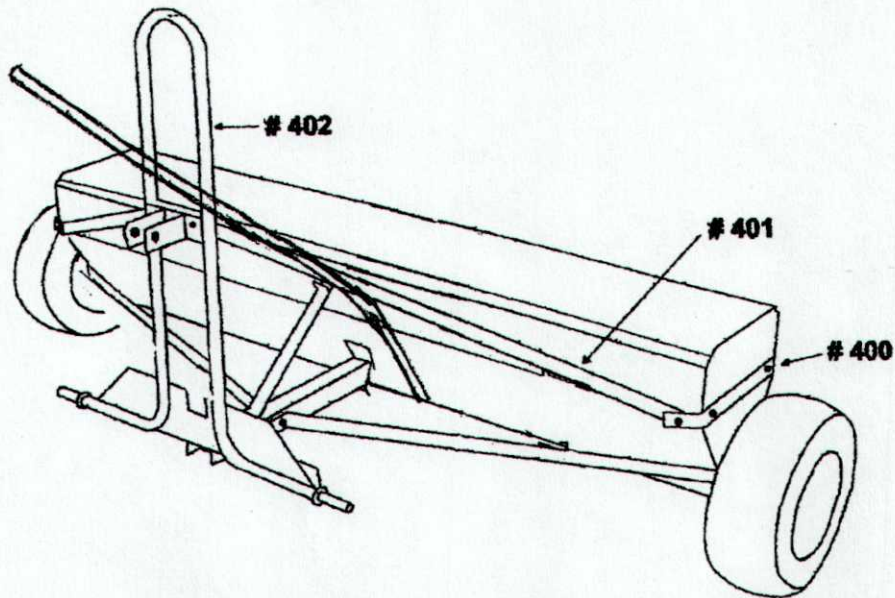

Parts List:

Name	Part Number	Number of pieces
Short Brace	#400	2
Long Brace	#401	2
Drop Spreader 3-Point Hitch	#402	1
5/16" x 2 1/2" bolt		1
5/16" x 2" bolt		2
5/16" x 1" bolt		6
5/16" nuts		9
5/16 lock washers		9

Drill 2 holes in each end of spreader box, 1" in from end and 5 1/4" down from top to mount short bracket #400.

Mount short brackets to box ends with 5/16x1" bolts.

Mount 3 pt hitch on present tongue with 5/16x2 1/2" bolt.

Mount long brackets #401 (1 per side from short braces to holes in 3 pt hitch). (Bent end mounts to 3 pt hitch with two 5/16x2" bolts) the other end mounts with 5/16x1" bolt to short bracket.